

# EAX-500 Operations

Ins No: 101321

NOTE: Depending on models ordered, delay times may vary

## SPECIAL NOTES and DEFINITIONS:

- The door needs to be closed to test the unit.
- When operating the ON/OFF switch, there is a slight delay.
- The key is inserted and removed only in the vertical position (home position).
- Key function: counter clockwise (CCW) = Armed; clockwise (CW) = Disarmed.
- The battery needs to be disconnected to register changes in the slide switches.
  - Status Indicator (This will affect battery life)
  - Disable Auto Rearm
- The bottom left switch is only used when the outside key control function is used.
- If re-handing is necessary remove battery and place magnet on left or right side and reconnect the battery.

## OPERATIONS:

To arm the system, close the door and turn the key counter clockwise (CCW) to the 8 o'clock position or until you feel and/or hear a click. The switch on the bottom right side of the board should be engaged by the plastic actuator and maintained. This is the 'ON' position. The red light should blink twice and the green light will come on solid for the arming time sequence (default 15 seconds). After the arming time, the green light will turn off and the unit will beep three times. At this time, the alarm is armed and if the door is opened the alarm will sound and the red light will turn on.

## DISARMING:

To turn off the alarm or disarm the system, turn the key clockwise (CW) to the 2 o'clock position. The bottom right switch should be released.

## TROUBLESHOOTING:

If the unit does not arm, the magnet may need to be re-aligned or shimmed closer to the EAX-500. If the unit fails to operate, confirm the slide switches are in the default condition (see step 4) and disconnect and reconnect the battery. If re-handing is necessary remove battery and place magnet on left or right side and reconnect the battery.

## LOW BATTERY ALERT:

- Siren will beep and red LED will blink at approximately 45 second intervals when battery is low

## STATUS INDICATOR:

- Slide the switch to ON and then, install battery.
- If the unit is armed, the red LED will blink every 3 seconds.
- If the unit is disarmed, the green LED will blink every 3 seconds.

## Disable AUTO REARM:

- Slide switch to OFF and then, install battery.
- Unit arms as described above.
- Once the unit is in full alarm and the door closes, the alarm will shut off after 2 minutes.

**Figure 1**  
Key orientation

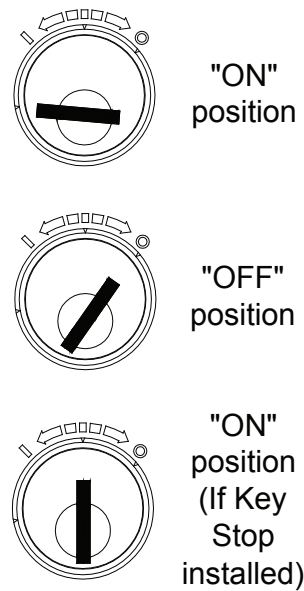

NOTE: Key Stop will prevent key removal in "OFF" position

**Front View**  
KEY STOP POSITIONS

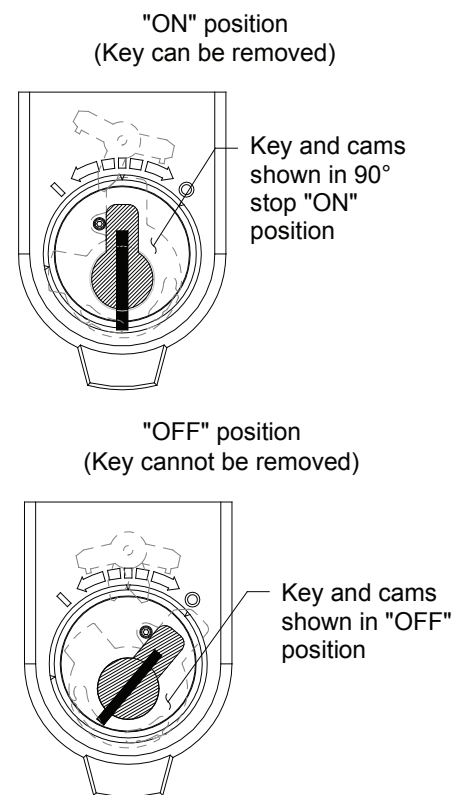

**Figure 2: KEY STOP INSTALLATION**  
(Key stop included in hardware kit)

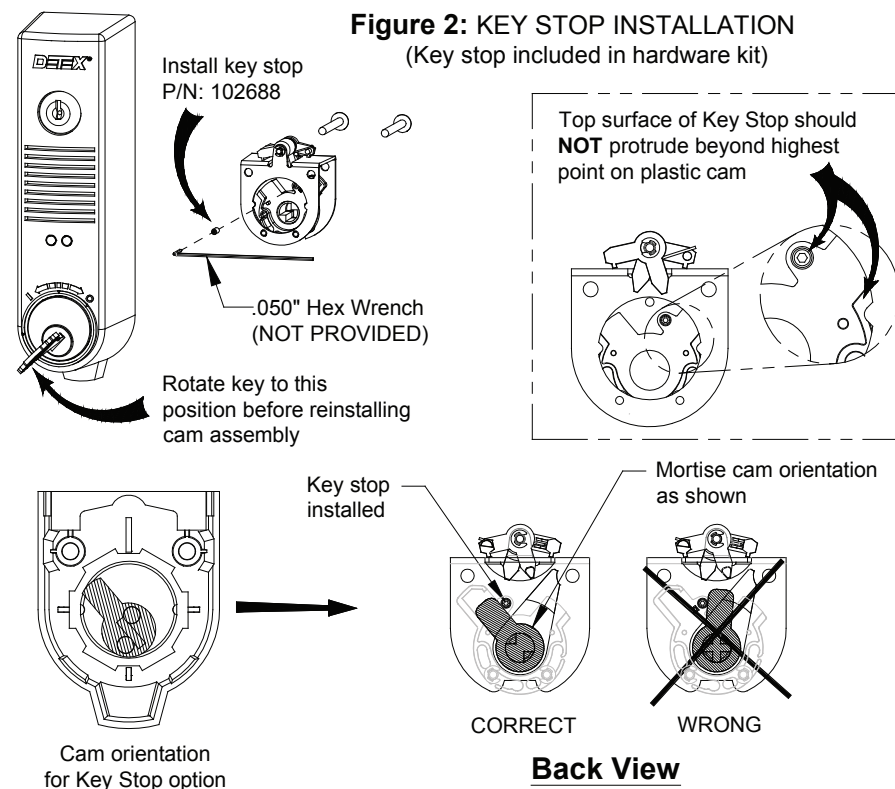

101321 September 15, 2008

Detex Corporation, 302 Detex Drive, New Braunfels, Texas 78130-3045  
(830)629-2900 / 1-800-729-3839 / Fax (830)620-6711  
E-MAIL: detex@detex.com INTERNET: www.detex.com

## INSTALLATION INSTRUCTIONS FOR THE EAX-500 EXIT ALARM

### U.S. PATENT NUMBERS:

20050257389  
20050231363  
20050223764

### Parts breakdown depiction (Mortise cylinder required)

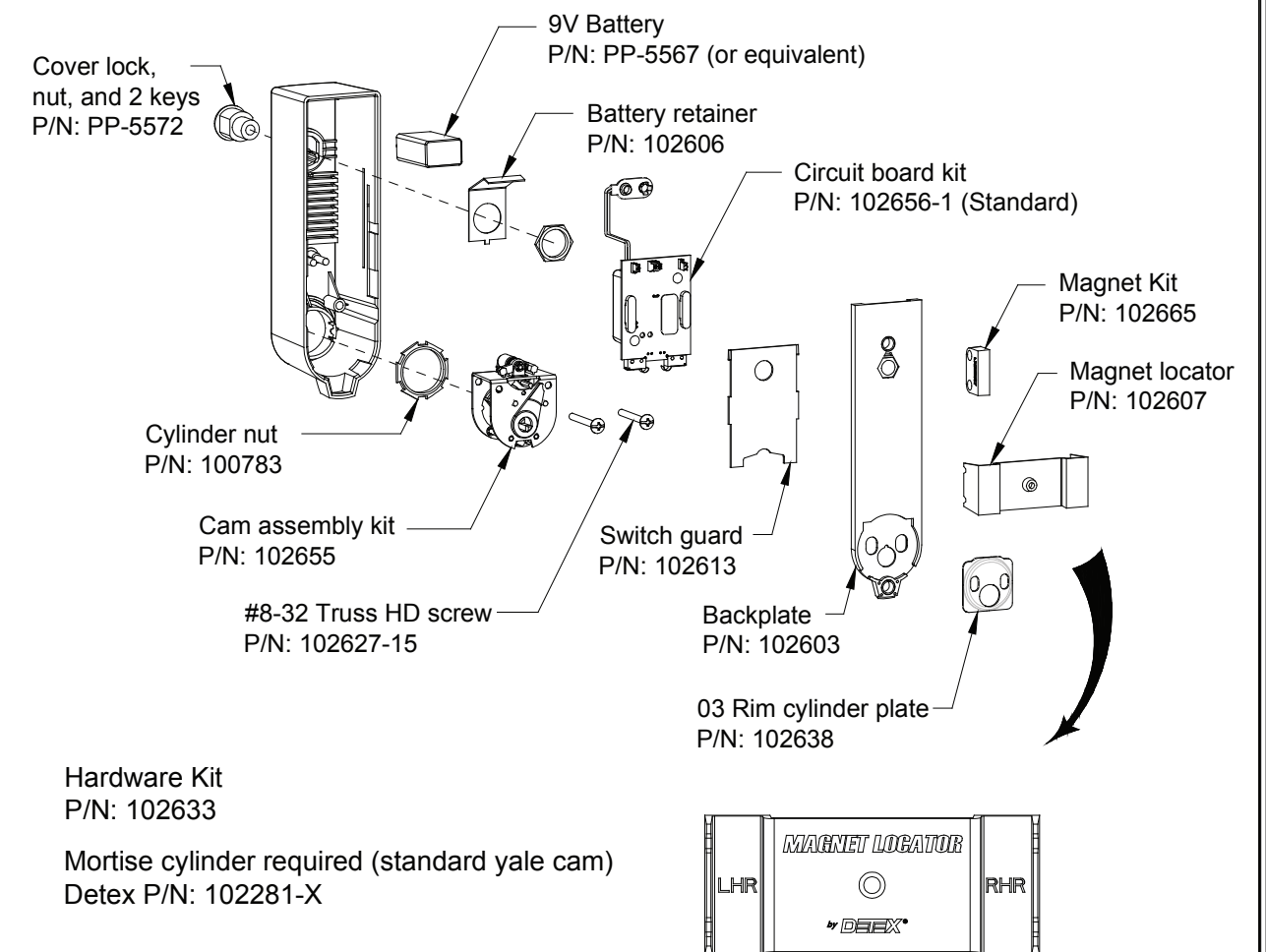

Locate this component for Step 6

# STEPS 1-5: PREP DEVICE

**1** Remove cam assembly from cover

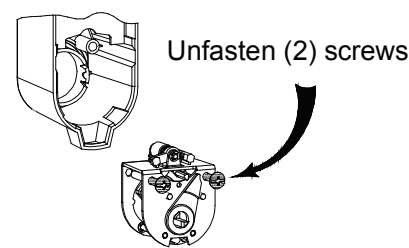

**2** Install mortise cylinder with cylinder nut provided  
**NOTE: For "Key Stop", See Figure 2**

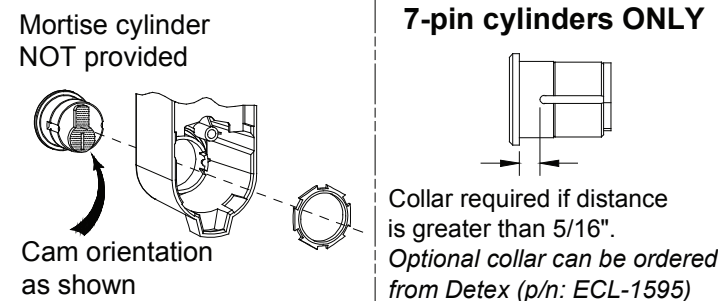

**3** Re-install cam assembly

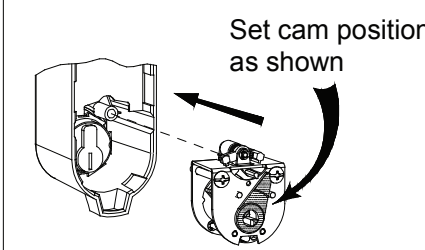

**4** Set selector switch functions (See Table A)  
Default settings

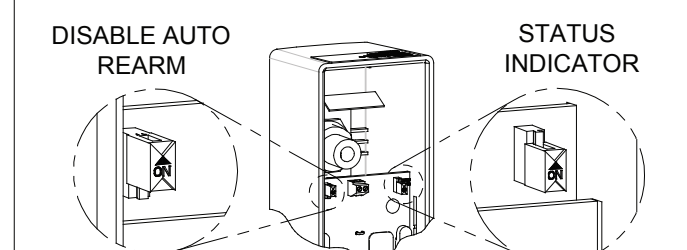

**5** Connect 9-volt battery and install as shown

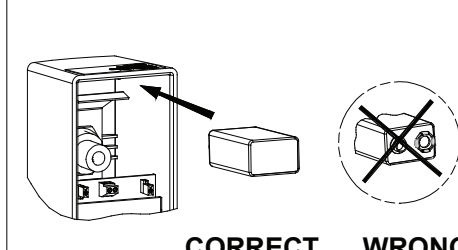

# STEP 6: PREP DOOR

**6** Mark/drill backplate and magnet holes on door and frame/mullion

NOTE: Remove locator and backplate prior to drilling mounting holes

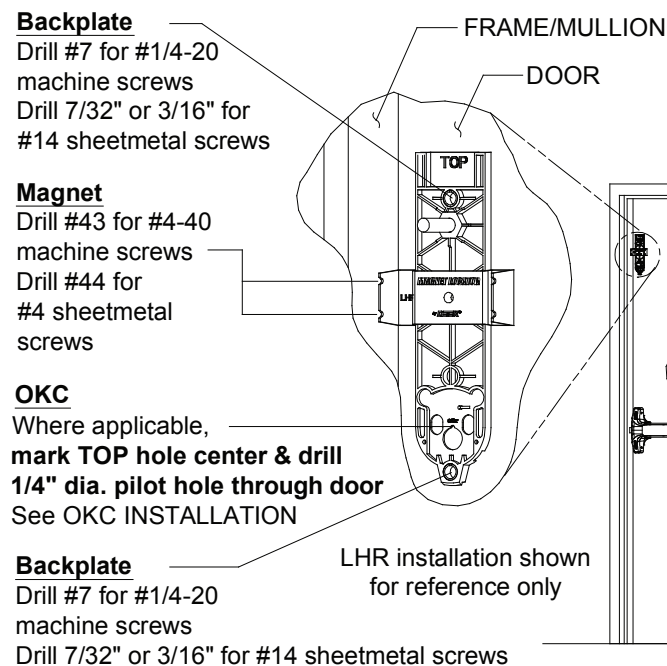

# STEP 7: INSTALL DEVICE

**7** Install magnet, backplate and cover

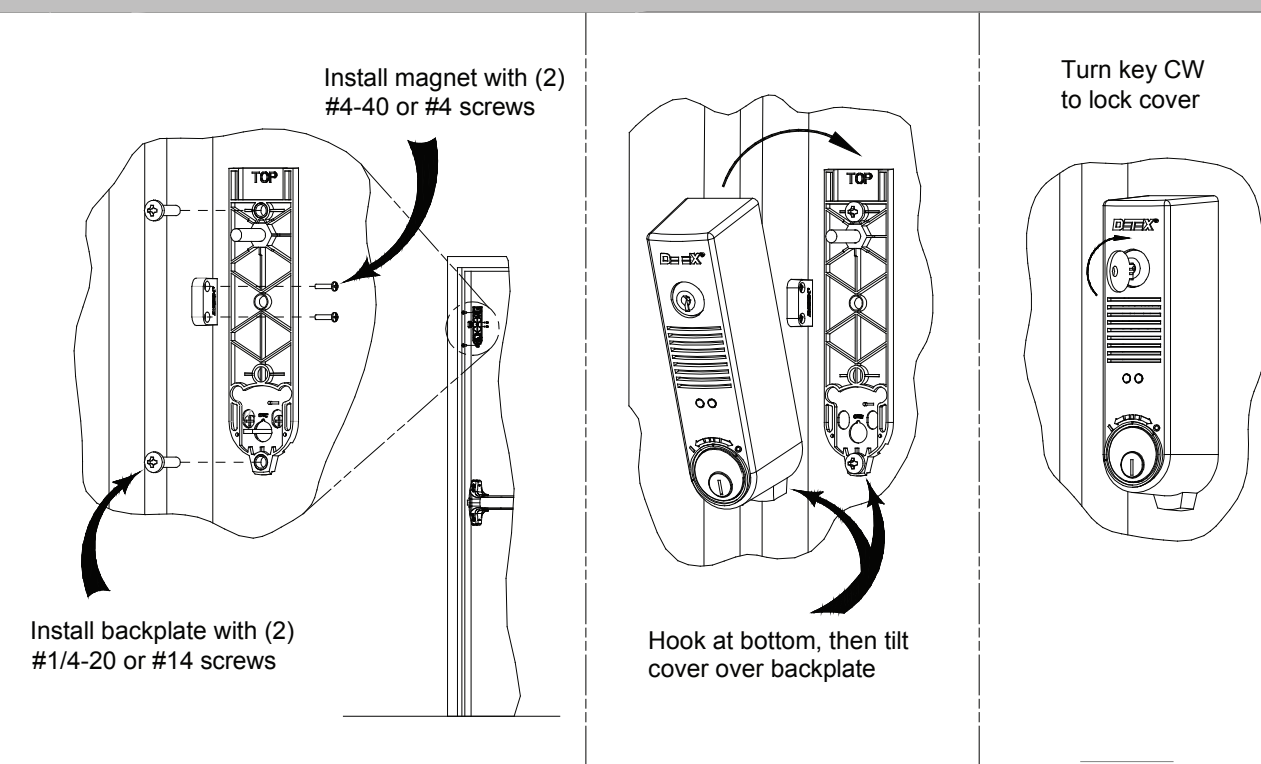

| STATUS INDICATOR   | STATUS DESCRIPTION   |
|--------------------|--|
| OFF*               | No indication that device is armed or disarmed.  |
| ON                 | ARMED - red LED blinks approximately every 3 seconds.**<br>DISARMED - green LED blinks approximately every 3 seconds.**                          |
| DISABLE AUTO REARM | STATUS DESCRIPTION   |
| OFF                | DEFAULT: Alarm will automatically rearm 2 minutes after alarm has been activated and door closed.<br>Custom settings can be programmed by DETEX. |
| ON*                | Alarm will not automatically rearm after alarm has been activated.   |

\*Default settings; \*\*Will shorten battery life

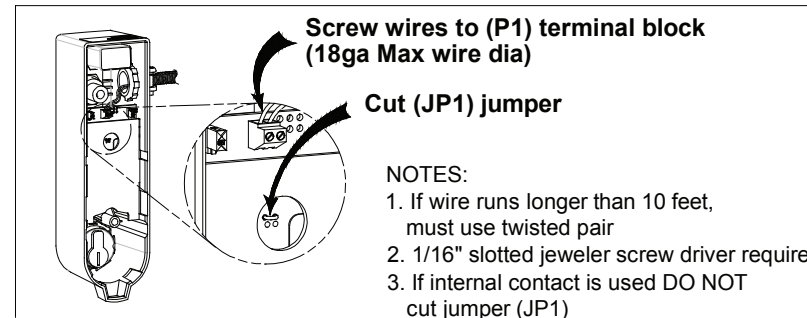

# Outside Key Control Installation

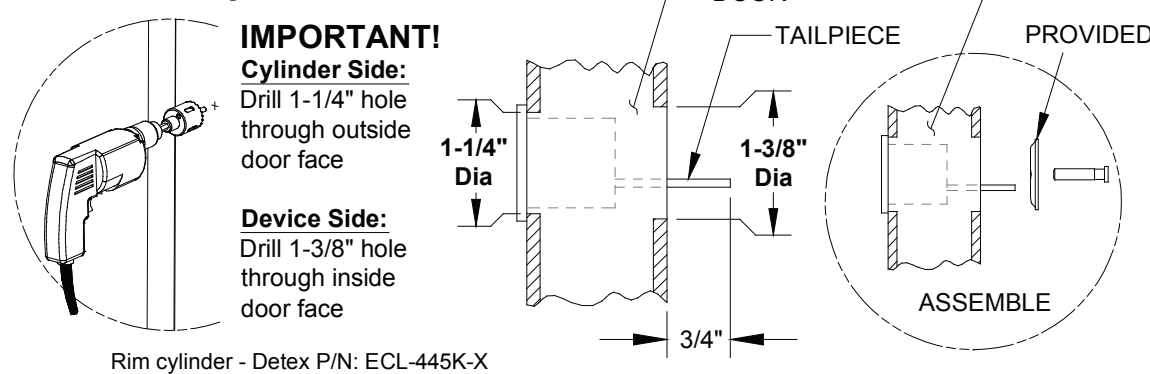

# MULTI-DOOR FUNCTION (Recommended installation)

